

Pressure relief valves

Type DV1000

NG 6 Bieri
up to 1000 bar



Features

- Directly operated
- High degree of pressure stability
- Safe function
- Flat characteristic
- Delivered only with released spring

Applications

- Pressure limitation in a dynamic pressure system

Design

- As cartridge
- As modular valve with one cartridges
- Seat construction
- The system pressure can be set to the required pressure via the adjusting spindle
- Pressure adjustment possible over the entire pressure range
- Fixing of the pre-set maximum pressure by lock nut
- Stable control behaviour thanks to damping piston

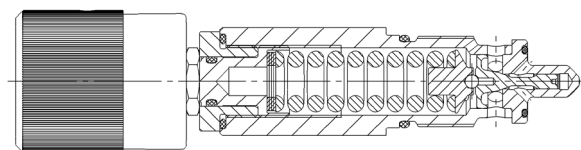

Technical data

Hydraulic fluid	mineral oil according to DIN 51524 (other fluids on request)	
Fluid temperature range	- 20 to 80 °C	
Ambient temperature range	- 30 to 50 °C	
Viscosity range	5 to 400 mm ² /s	
Porting	NG 6 according to Bieri standard	
Max. operating pressure connection P, A, B	1000 bar	
Max. operating pressure connection T	350 bar	
Max. flow rate	25 l/min	
Filtration (recommendation)	according to NAS 1638 class 6 resp. ISO/DIN 4406 17/15/12	
Weight	see overview "Product informations"	
Material	housing	Steel, galvanized
	cartridge	Steel corrosion resistant
	adjusting knob	Plastic

Product informations

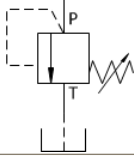
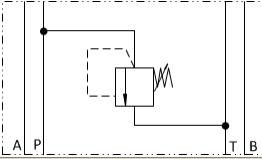
Design	E
Part No.	4249629
Symbol	
Weight	0,2 kg
Design	P
Part No.	4301256
Symbol	
Weight	1,0 kg

Dimensinal drawings

Cartridge

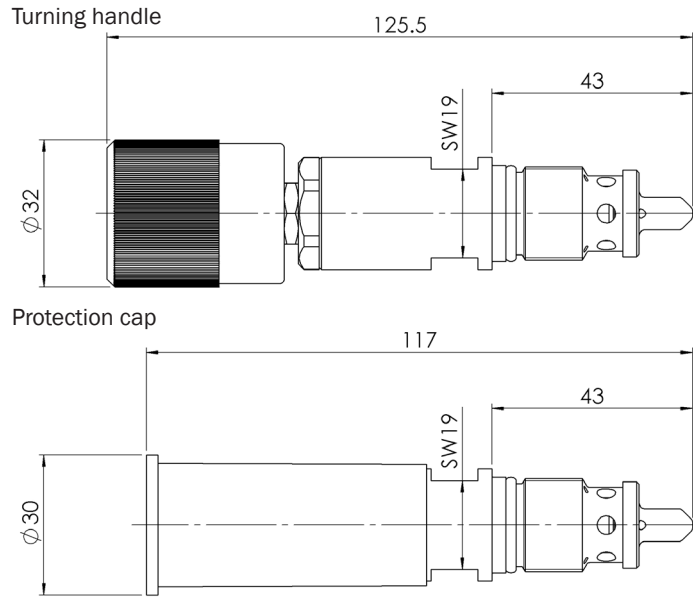

Cartridge cavity

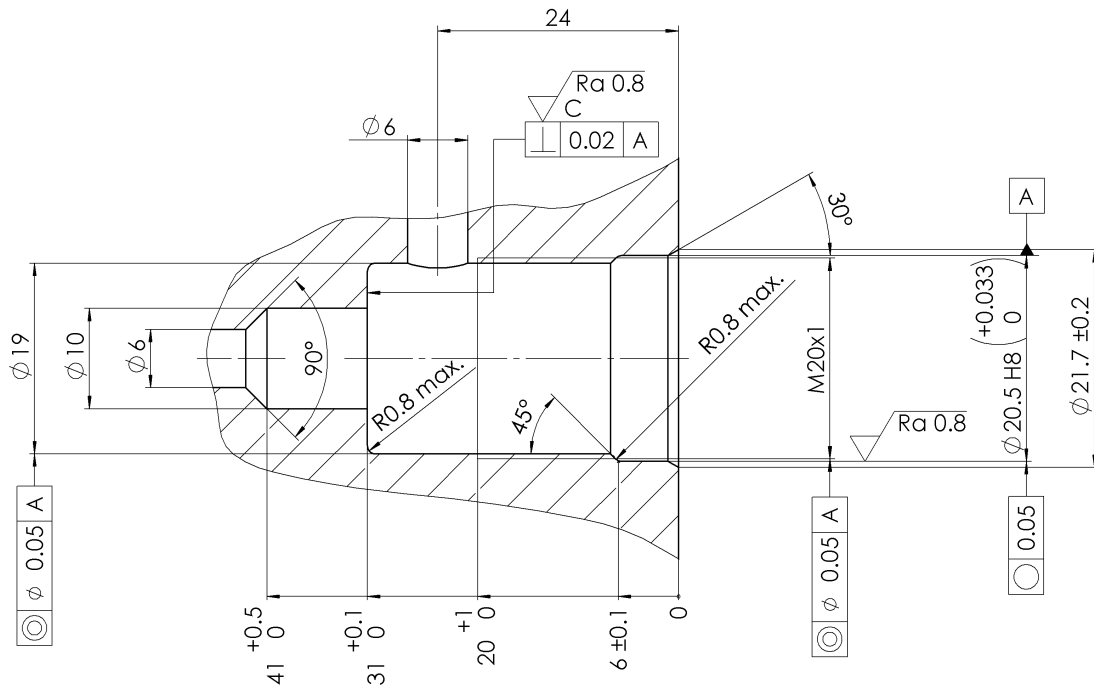

Modular subplate from P to T

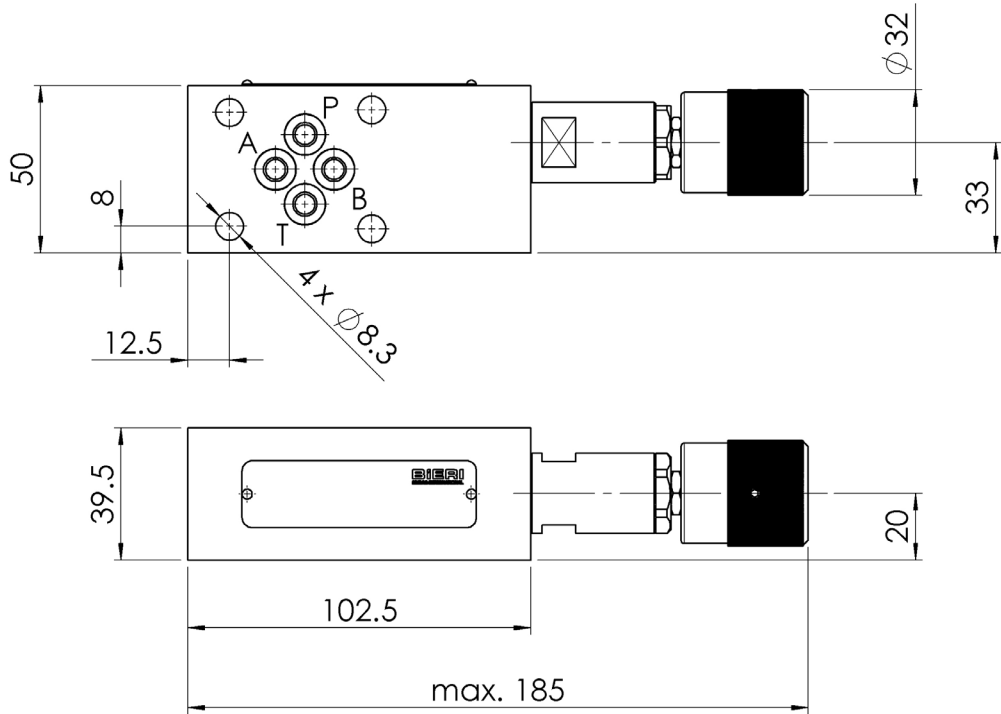

Drilling pattern

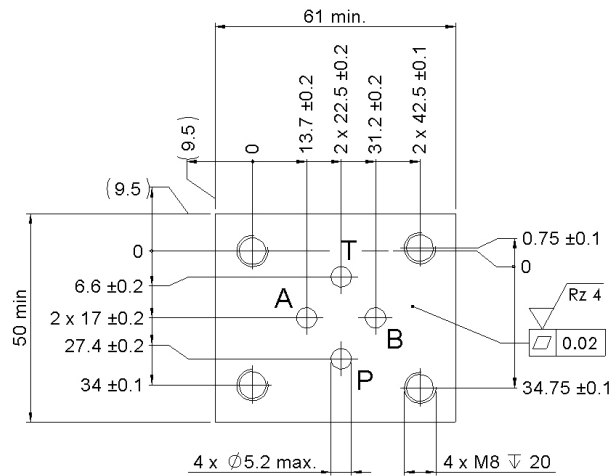

Type DV1000

NG 6 Bieri
up to 1000 bar

Valve block for in-line mounting

Type	Weight	Part No.
VKR-6-DV1000	0,7 kg	4296553

Dimensional drawing

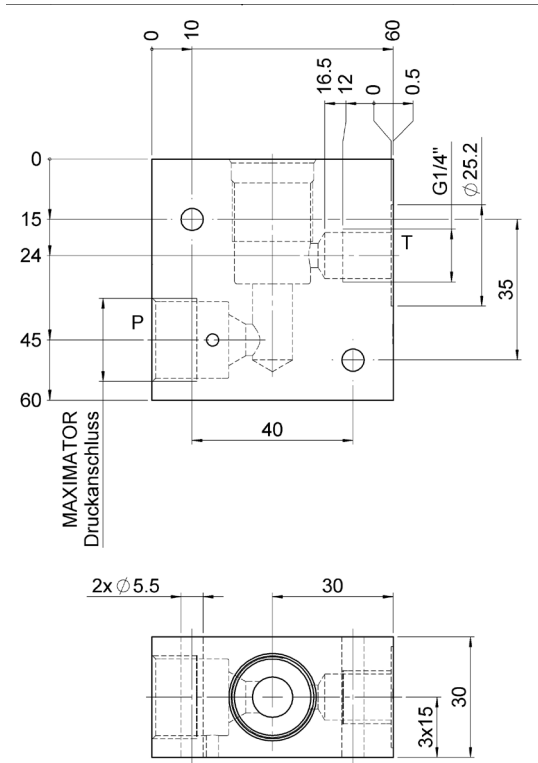

Dimensional drawing with pressure relief cartridge (Cartridge not included in scope of supply)

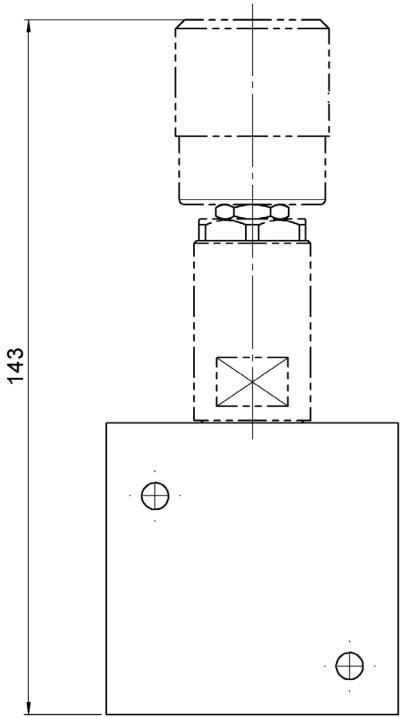

Accessories

item description	part no.
pressure collar MAXIMATOR	6166302
pressure gland MAXIMATOR	6166305
adapter G1/4" MAXIMATOR	3939573

Anschluss "P" mit MAXIMATOR-Verrohrung Connection "P" with MAXIMATOR piping

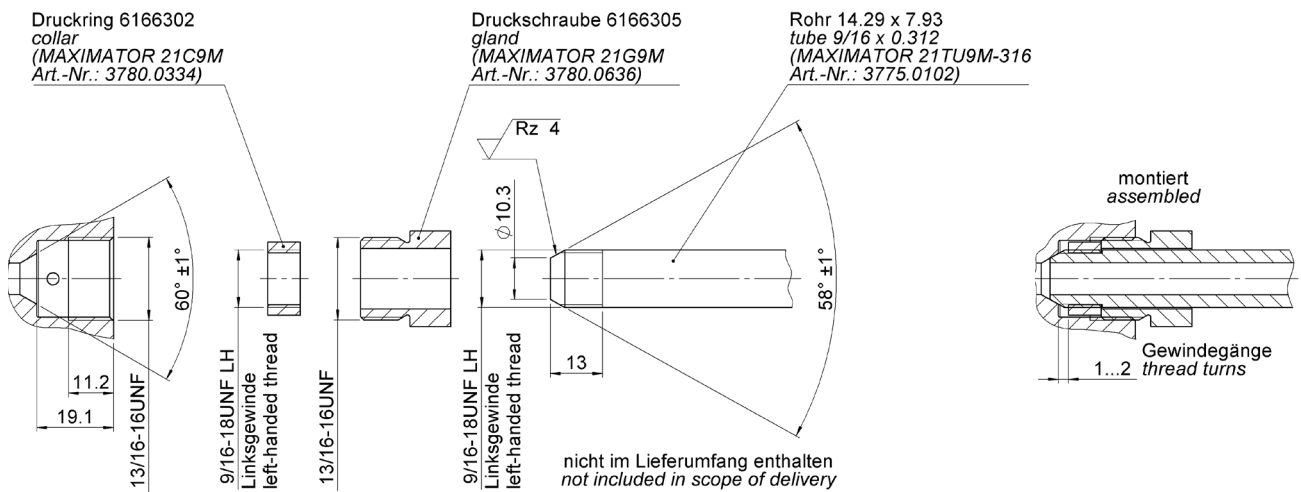

Anschluss "P" mit System-Anschluss G1/4" Connection "P" with system adapter G1/4"

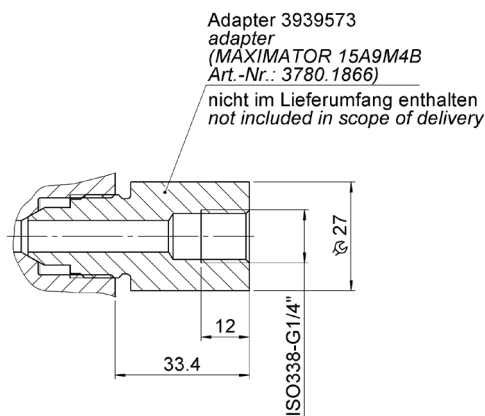

Characteristics

Measured at $v = 32 \text{ mm}^2/\text{s}$, $T = 40^\circ\text{C}$

