

Throttle/Throttle check valves

Type SD700/SDRV700
NG 6 ISO
up to 25 l/min, up to **700 bar**

Features

- Adjustable while under pressure
- High-precision control
- Bi-directional flow



Applications

- To change the speed of movement of a consumer
- Throttle valves for inlet and outlet throttling
- Throttle check valves as screw-in cartridge or intermediate plate valve (for applications where the flow shall be throttled in one direction and be unthrottled in the other direction)

Design

- Cartridge alone or in manifolds
- The valve setting can be locked by a counter nut





Technical data

Hydraulic fluid	mineral oil according to DIN 51524 (other fluids on request)	
Fluid temperature range	-20 to 80 °C	
Ambient temperature range	-30 to 50 °C	
Viscosity range	5 to 400 mm ² /s	
Porting	NG 6 according to DIN 24340 / ISO 4401 / CETOP RP 121 H	
Max. operating pressure connection P, A, B	700 bar	
Max. operating pressure connection T	350 bar	
Max. flow rate	25 l/min	
Filtration (recommendation)	according to NAS 1638 class 6 resp. ISO/DIN 4406 17/15/12	
Weight	see overview "Product information"	
Materials	valve body:	corrosion-resistant steel
	cartridge body:	steel
	supporting ring:	cast iron

Type code

Example		SDRV	700	-	6	-	AABB	-	Z	-	V	-	A		00	
Throttle valves	SD															Design 00 ... 99 For internal purposes
Throttle check valves	SDRV															
Size	700 bar															
Nominal size	6															Index Please leave blank For internal purposes
Throttle valves																
Throttle check valves																
E	Cartridge															Design revision For internal purposes
AA	Throttle check valve in A															
BB	Throttle check valve in B															
AABB	Throttle check valve in A and B															
Direction of throttling																
X	For throttle valve SD															
Z	Outgoing throttling															
A	Return throttling															
Seal material	V FKM other seal materials on request															

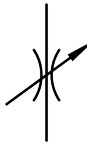
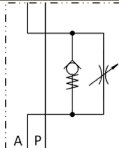
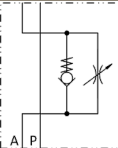
Product information

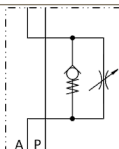
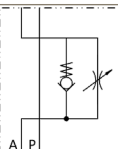
Valve type	SD			
Design	E			
Type code	SD700-6-E-X-V-A*00			
Part No.	3677847			
Symbol				
Weight	0,12 kg			
Valve type	SDRV			
Design	AA		BB	
Direction of throttling	A	Z	A	Z
Type code	SDRV700-6-AA-A-V-A*00	SDRV700-6-AA-Z-V-A*00	SDRV700-6-BB-A-V-A*00	SDRV700-6-BB-Z-V-A*00
Part No.	on request	on request	on request	on request
Symbol				
Weight	1,9 kg	1,9 kg	1,9 kg	1,9 kg
Valve type	SDRV			
Design	AABB			
Direction of throttling	A	Z		
Type code	SDRV700-6-AABB-A-V-A*00	SDRV700-6-AABB-Z-V-A*00		
Part No.	on request	on request		
Symbol				
Weight	1,9 kg	1,9 kg		

Dimensional drawings

SD700

E

Cavity E

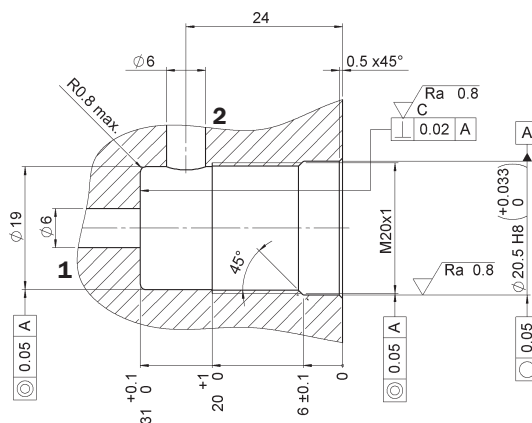
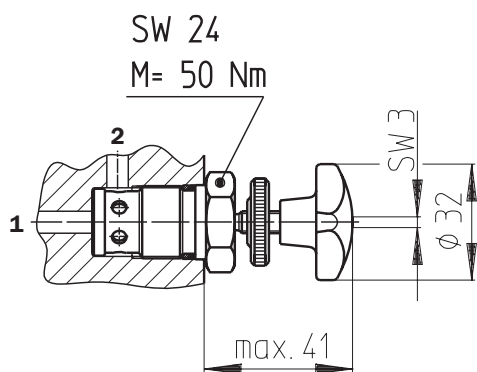

Cartridge check valve see technical data sheet ZP700/BL700/RV700

SDRV700

AA

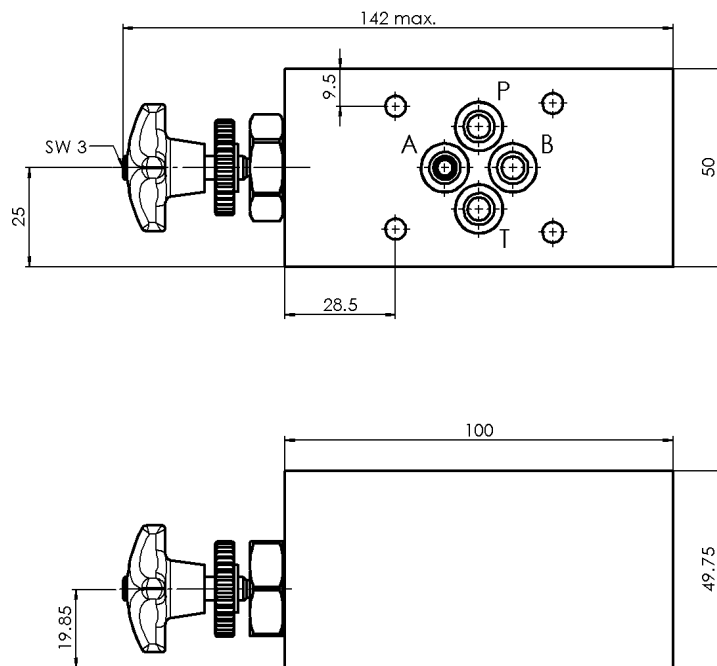

BB

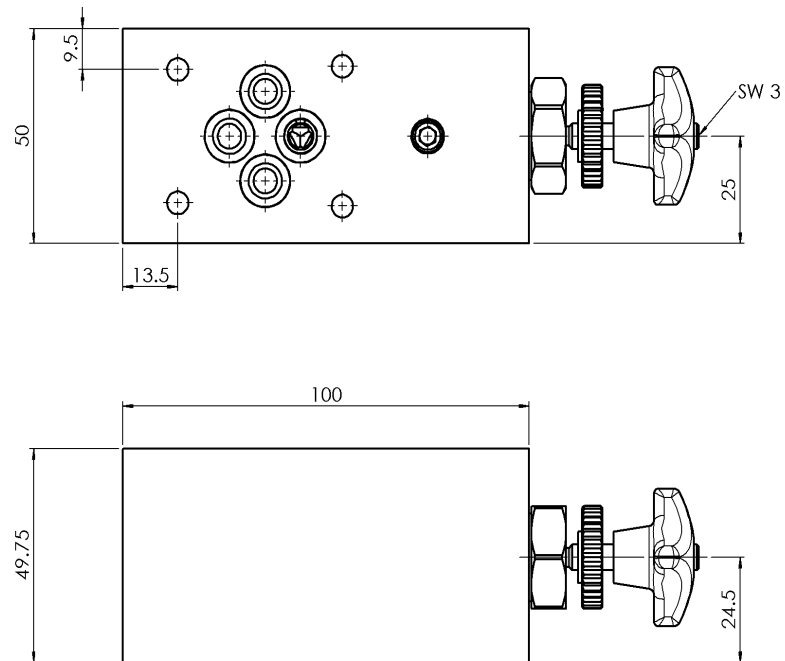

AABB

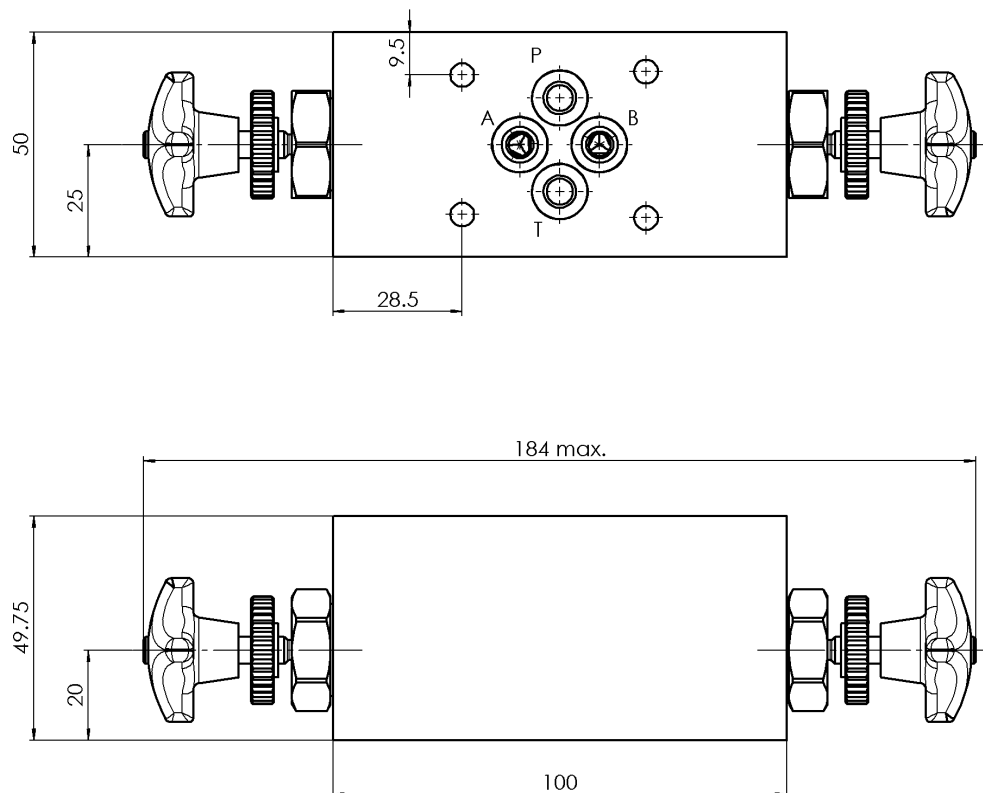

Drilling pattern

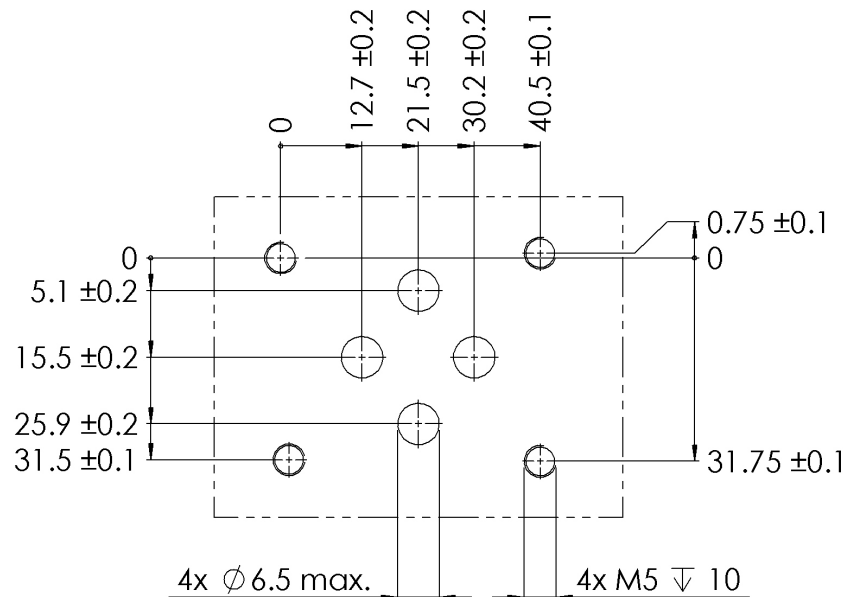

Pressure drop for throttle valve

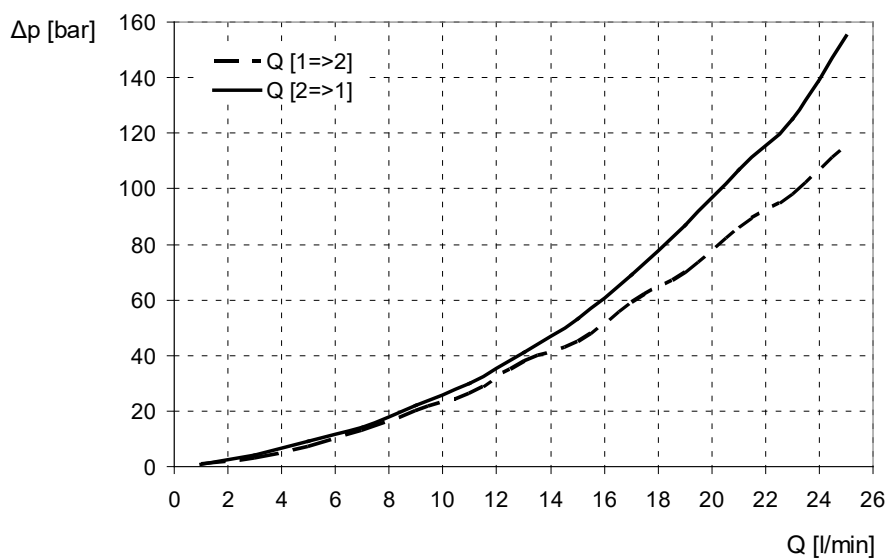

Bieri Hydraulik AG

Könizstrasse 274
CH-3097 Liebefeld
Tel. +41 31 970 09 09 | Fax +41 31 970 09 10
info@bieri hydraulics.com | www.bieri hydraulics.com

The information in this brochure relates to the operating conditions and applications described.

For applications and operating conditions not described, please contact the relevant technical department.

Subject to technical modifications.